

**Minnesota Department of Agriculture
Plant Protection Division/Grain Licensing Program**

Warehouse Diagram

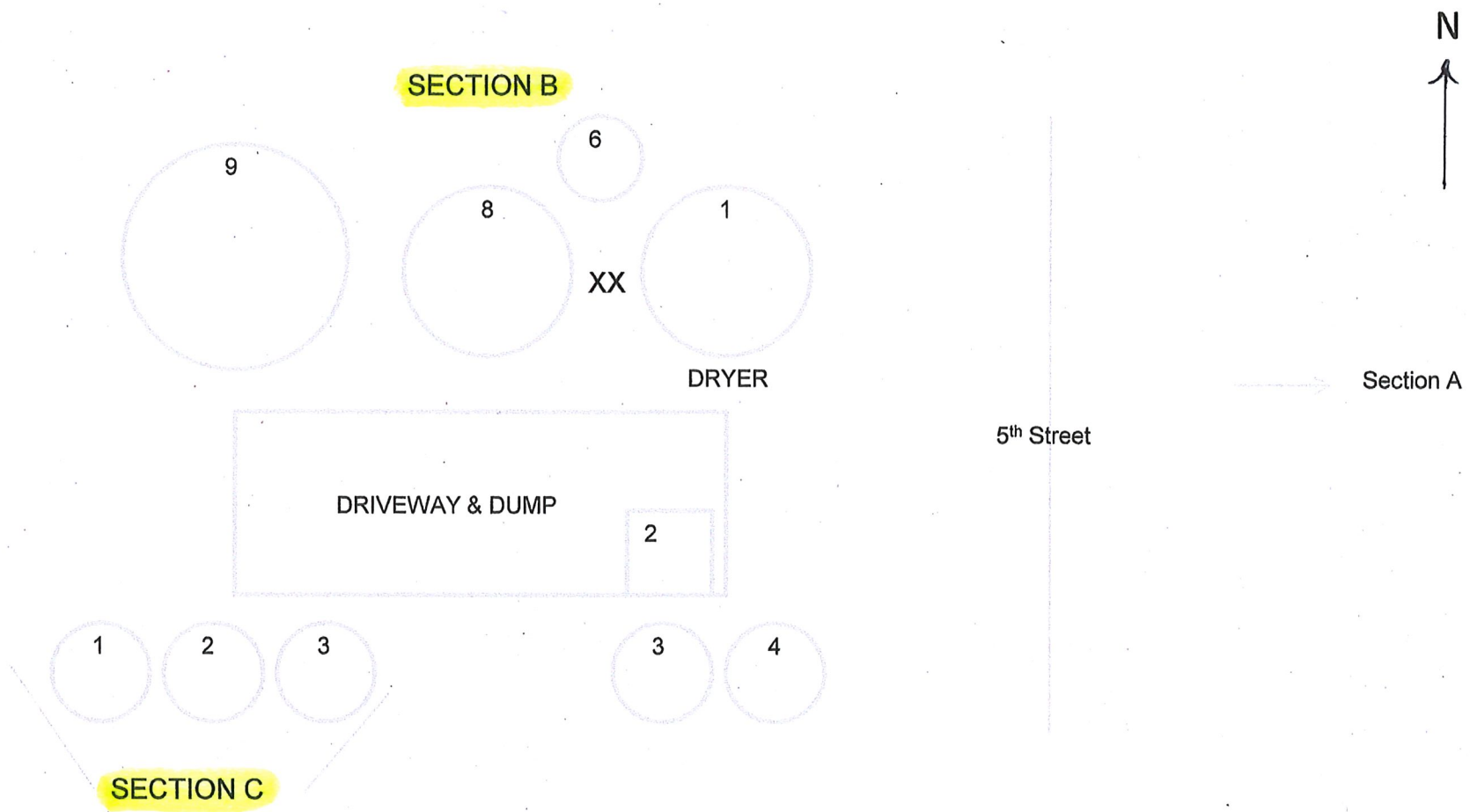

Warehouse Name/Location	County	Code/Firm	Bin Site
Hawley Cooperative Elevator Co.	Hawley, MN. Clay	2-0525	Section B & C



Client ID: 20525

Minnesota Bin Capacity Chart

12/14/2011 10:48:37 AM

Exam Date: 12/14/2011

HAWLEY COOPERATIVE ELEVATOR CO.
 316 5th STREET PO BOX 9
 HAWLEY, MN
 County: Clay

Page: 7

Examiner: Rengo

Status	Section	Bin Number	Bin Type	Base Point	Diameter or Bu/Ft (Irreg).		Side wall	Add for Hopper	Effective Depth	Add for Peak	Depth for Capac.	Bushels per Foot	Base Pack%	Bushel Capacity with Pack
					Length	Width								

Facility: Hawley**Section: A**

A	Tank 301	Round	Top of sidewalls. 6-11-08	27.000	0.000	0.000	39.50	0.000	38.000	0.000	38.0	460.3	8.50	18,978
A	Tank 302	Round	Top of sidewalls. 6-11-08	27.000	0.000	0.000	39.50	0.000	37.000	0.000	37.0	460.3	8.50	18,479
A	Tank 303	Round	Top of sidewalls. 6-11-08	27.000	0.000	0.000	39.50	0.000	38.000	0.000	38.0	460.3	8.50	18,978
A	Tank 304	Round	Top of sidewalls. 6-11-08	27.000	0.000	0.000	39.50	0.000	38.000	0.000	38.0	460.3	8.50	18,978
A	Tank 305	Round	Top of sidewalls. 6-11-08	27.000	0.000	0.000	39.50	0.000	38.000	0.000	38.0	460.3	8.50	18,978
A	Tank 306	Round	Top of sidewalls. 6-11-08	27.000	0.000	0.000	39.50	0.000	38.000	0.000	38.0	460.3	8.50	18,978
A	Tank 307	Round	Top of sidewalls.	22.000	0.000	0.000	10.80	3.200	14.000	0.000	14.0	305.6	7.20	4,586
A	Tank 308	Round	Top of sidewalls.	15.000	0.000	0.000	16.00	3.000	19.000	0.000	19.0	142.1	5.50	2,848
A	Tank 309	Round	Top of sidewalls.	15.000	0.000	0.000	16.00	3.000	19.000	0.000	19.0	142.1	5.50	2,848

Facility: Hawley Section: A Total: 306,935

To Even: **307,000**

Section: B

B	01	Peaked	Top of sidewalls	42.000	0.000	0.000	40.50	0.000	40.500	2.500	43.0	1113.7	10.0	52,678
B	02	Flat	Top of sidewalls.	0.000	12.00	12.00	21.00	0.000	21.000	0.000	21.0	115.8	6.20	2,583

Client ID: 20525

Minnesota Bin Capacity Chart

12/14/2011 10:48:37 AM

Exam Date: 12/14/2011

HAWLEY COOPERATIVE ELEVATOR CO.

Page: 8

Examiner: Rengo

316 5th STREET PO BOX 9

HAWLEY, MN

County: Clay

Status	Section	Bin Number	Bin Type	Base Point	Diameter or Bu/Ft (Irreg).		Side wall	Add for Hopper	Effective Depth	Add for Peak	Depth for Capac.	Bushels per Foot	Base Pack%	Bushel Capacity with Pack
					Length	Width								

Facility: Hawley**Section: B**

B	03	Round	Top of sidewalls.	19.000	0.000	0.000	21.00	3.300	24.300	0.000	24.3	227.9	6.20	5,881
B	04	Round	Top of sidewalls.	19.000	0.000	0.000	21.00	3.300	24.300	0.000	24.3	227.9	6.20	5,881
B	06	Round	Top of sidewalls.	18.000	0.000	0.000	32.00	3.000	35.000	0.000	35.0	204.6	6.00	7,591
B	08	Peaked	Top of sidewalls.	42.000	0.000	0.000	40.50	0.000	40.500	2.500	43.0	1113.7	10.0	52,678
B	09	Peaked	Top of sidewalls.	48.000	0.000	0.000	59.00	0.000	59.000	4.300	63.3	1454.6	10.0	101,284

Facility: Hawley Section: B Total: 228,576To Even: **229,000****Section: C**

C	TANK 1	Peaked	Top of sidewalls.	13.600	0.000	0.000	20.00	2.000	22.000	0.800	22.8	116.8	5.20	2,801
C	TANK 2	Peaked	Top of sidewalls.	13.600	0.000	0.000	20.00	2.000	22.000	0.800	22.8	116.8	5.20	2,801
C	TANK 3	Peaked	Top of sidewalls.	13.600	0.000	0.000	20.00	2.000	22.000	0.800	22.8	116.8	5.20	2,801

Facility: Hawley Section: C Total: 8,403To Even: **9,000**